

CARGO MANAGER ASSEMBLY AND INSTALLATION INSTRUCTIONS

(OPERATION AND USE INSTRUCTIONS ON REVERSE SIDE)

STEP 1 Attach Cargo Manager tracks to Roll-N-Lock tracks. (Roll-N-Lock must be installed first).
 Note: Cargo Manager will function correctly only if the Roll-N-Lock tracks are correctly positioned (perpendicular to bed rail and parallel). Check Roll-N-Lock tracks for straightness before attaching Cargo Manager tracks. Note that the mounting flange of the Cargo Manager track is designed to overlay existing screw heads in the Roll-N-Lock track, permitting attachment in the holes between. Position the Cargo Manager track with the specially machined end toward the tailgate and the straight cut end approximately 1/2 inch from the Roll-N-Lock housing. When correctly positioned, the holes in both tracks will align. Place an attaching screw (10-24 X 1/2" truss head phillips) in the first available hole at each end of the track and equally space the two remaining screws in the holes available.

STEP 2 Assemble driver side tram plate.

STEP 3 Assemble passenger side tram plate.

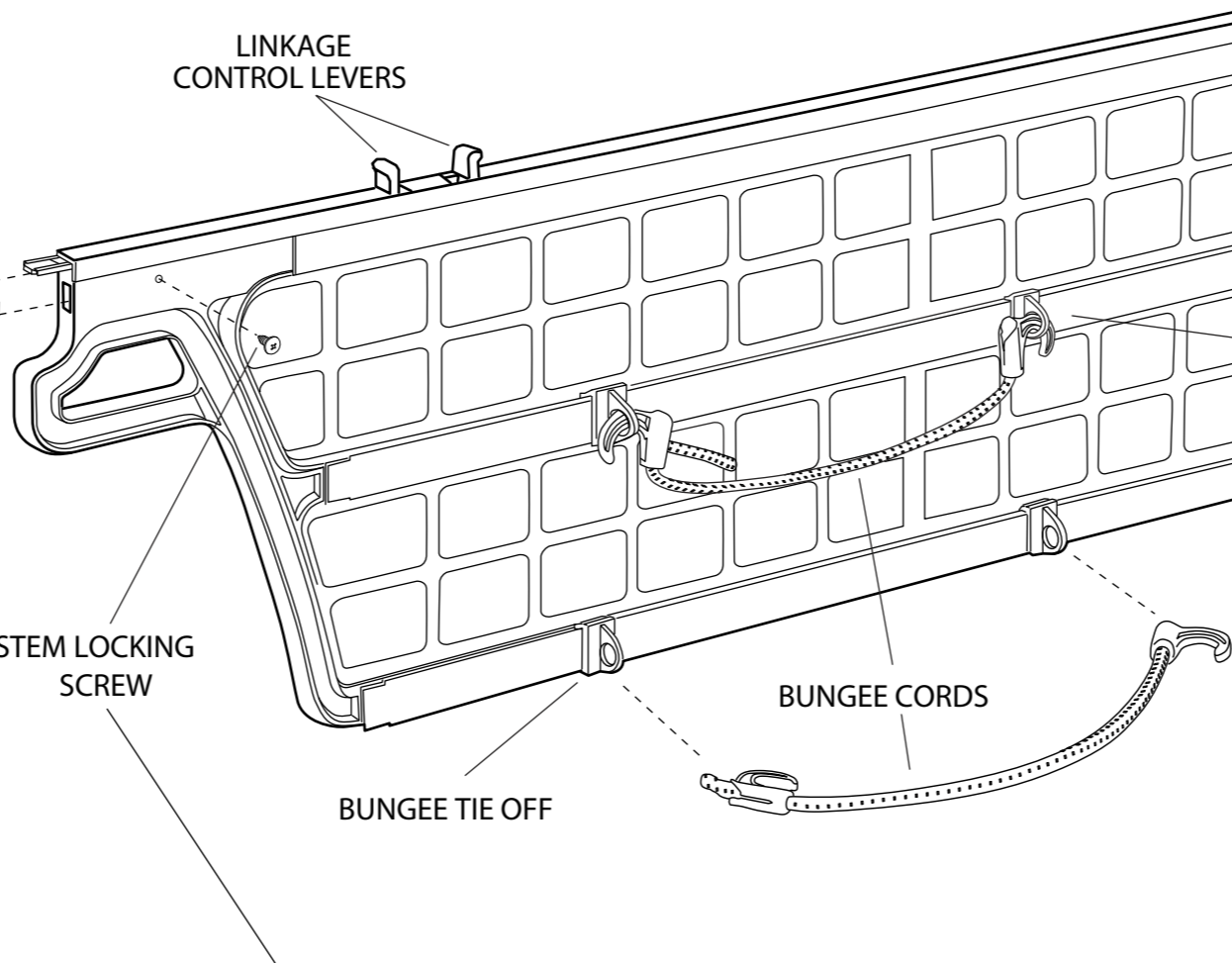
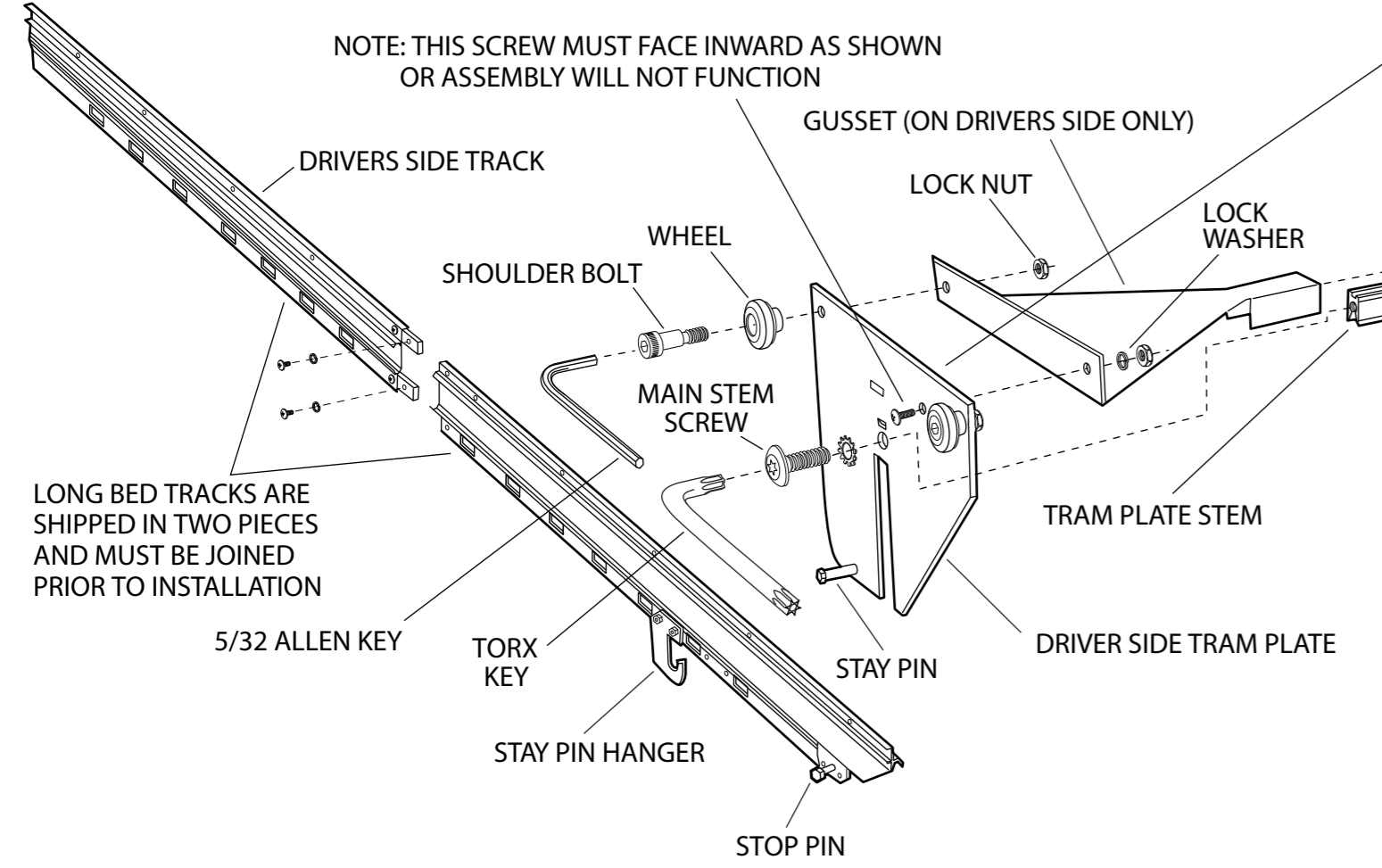
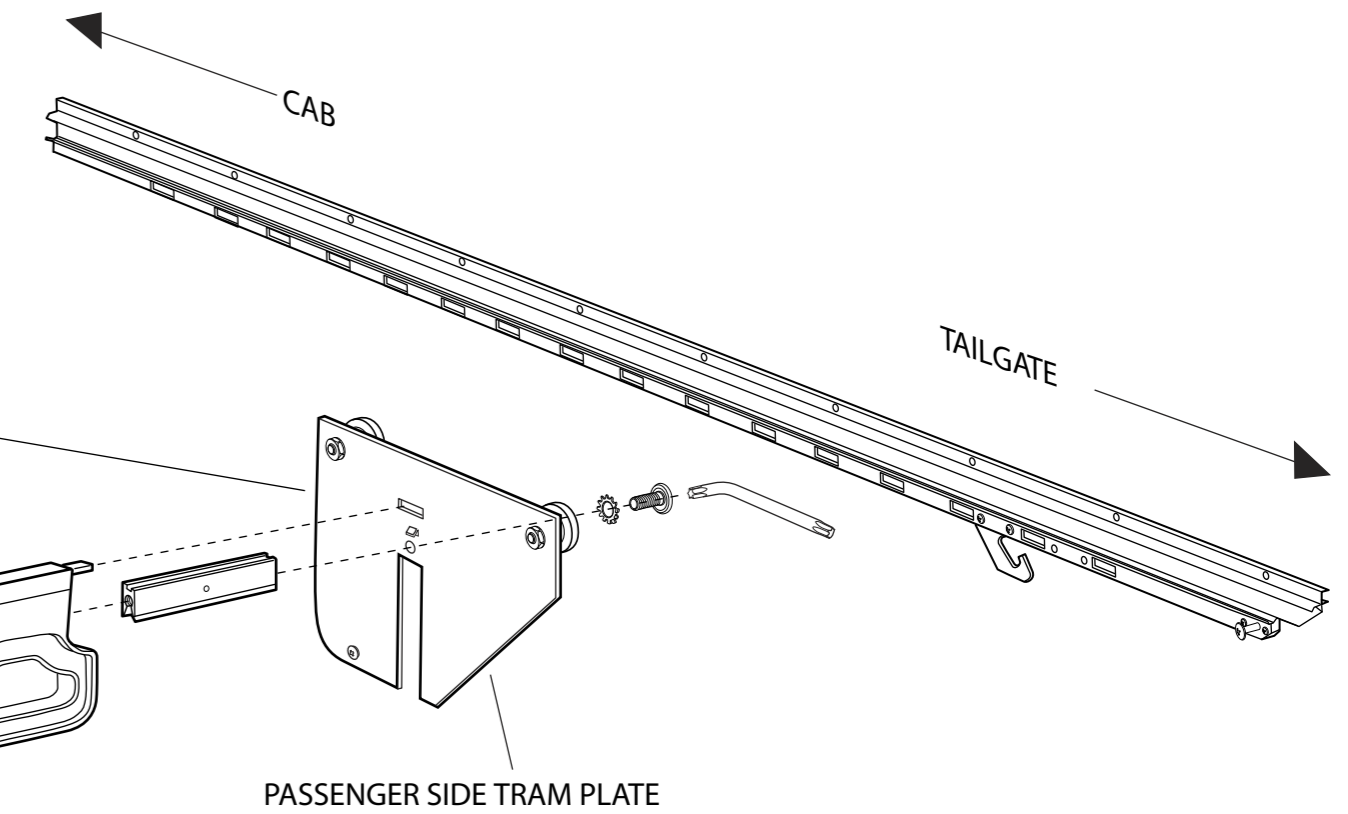

STEP 5 Install the assembled Cargo Manager divider into the tracks. To do so requires that you press the track stop pins in to permit the wheels to enter the tracks (see photo reverse side). Then maneuver the Cargo Manager divider around the back bed posts and rotate the divider to the vertical position, then align and insert rear wheels. With the lead wheels in place, squeeze the linkage control levers to retract the linkage and rotate the divider to the vertical position, then align and insert rear wheels. With the wheels in place, press the track stop pins out to prevent the wheels from leaving the tracks.

STEP 4 Slide tram plates onto ends of cargo manager divider and secure stem locking screw on drivers side being sure that screw enters hole in stem.
 Note: Do not place screw in passenger side.

STEP 6 Testing Cargo Manager. Squeeze and hold the linkage control levers and the Cargo Manager divider should glide effortlessly along the tracks. When levers are released, the linkage should snap into the first available location slots in the direction you are traveling. If the divider was assembled correctly and does not function as described, the problem is not the Cargo Manager, it is incorrect alignment of the Roll-N-Lock tracks as mentioned in Step one. For Cargo Manager to function correctly the Roll-N-Lock tracks must not pitch downward or be out of parallel. Note: It is not necessary to lubricate the tracks. Cargo Manager is designed to function effortlessly without lubrication.